



PLAN TOPOGRAFIC

Sc 1:250
INTRAVILAN

Com. Feleacu, Loc. Feleacu, Jud. Cluj
CF Nr. 60594 Feleacu, Nr. Cad: 60594
Beneficiar: Moldovan Tudor-Vasile

LEGENDA:

-  limita zonei studiate
-  limita de proprietate conform C.F.
-  strazi amenajate existente

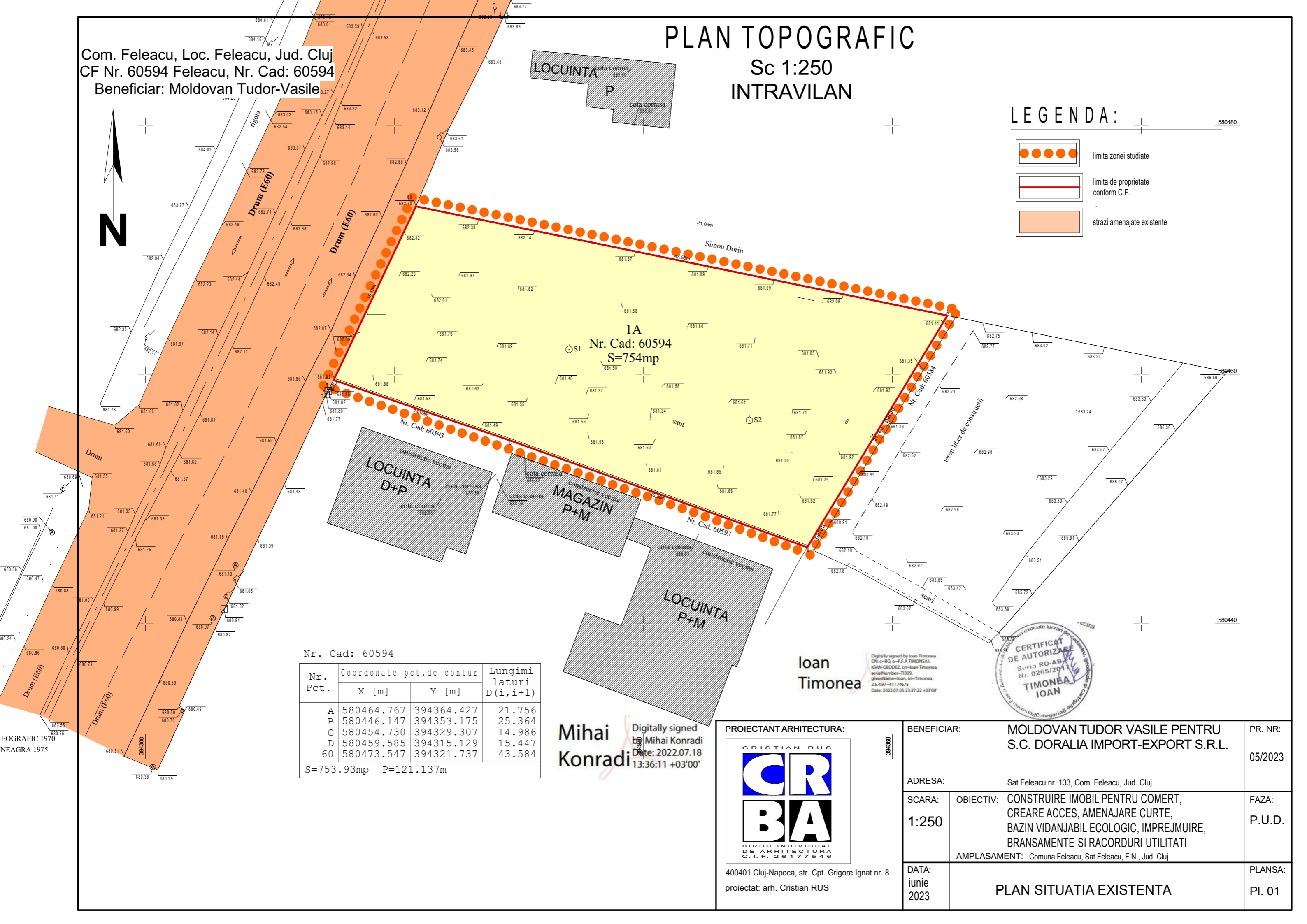
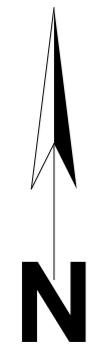

Nr. Cad: 60594

Nr. Pct.	Coordonate pct.de contur		Lungimi laturi D(i, i+1)
	X [m]	Y [m]	
A	580464.767	394364.427	21.756
B	580446.147	394353.175	25.364
C	580454.730	394329.307	14.986
D	580459.585	394315.129	15.447
60	580473.547	394321.737	43.584
S=753.93mp P=121.137m			

Mihai Konradi
Digitally signed by Mihai Konradi
Date: 2022.07.18 13:36:11 +03'00'

Ioan Timonea

Digitally signed by Ioan Timonea
DNE c-RO, o=P.F.A TIMONEA I.
IOAN-GEORGEZ, cn=Ioan Timonea,
serialNumber=13399,
givenName=Ioan, ou=Timonea,
2.5.4.97-41174675
Date: 2022.07.05 23:37:22 +03'00'



PROIECTANT ARHITECTURA:



400401 Cluj-Napoca, str. Cpt. Grigore Ignat nr. 8
proiectat: arh. Cristian RUS

BENEFICIAR:	MOLDOVAN TUDOR VASILE PENTRU S.C. DORALIA IMPORT-EXPORT S.R.L.	PR. NR:	05/2023
ADRESA:	Sat Feleacu nr. 133, Com. Feleacu, Jud. Cluj	FAZA:	P.U.D.
SCARA:	1:250	OBIECTIV:	CONSTRUIRE IMOBIL PENTRU COMERT, CREARE ACCES, AMENAJARE CURTE, BAZIN VIDANJABIL ECOLOGIC, IMPREJMUIRE, BRANSAMENTE SI RACORDURI UTILITATI
DATA:	ieunie 2023	AMPLASAMENT:	Comuna Feleacu, Sat Feleacu, F.N., Jud. Cluj
	PLAN SITUATIA EXISTENTA	PLANSA:	PI. 01